

TUF-S / TU-S / TUC-S

1. Pre-drill the panel

Pre-drill using a $\varnothing 6$ mm blind-hole drill with depth stop



The geometry of the drill hole shall be checked minimum on 1% of all drillings. **Nominal measure: $\varnothing 5,9 - 6,0$ mm**

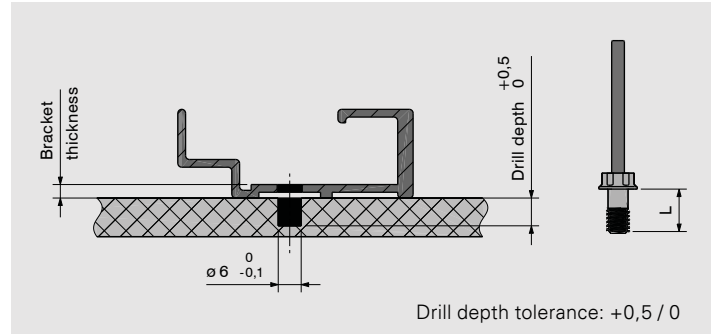

TUF-S Length - Bracket Thickness = TUF-S Drill depth
TU-S Length - Bracket Thickness + 0,5 mm = TU-S Drill depth
TUC-S Length - Bracket Thickness + 1,0 mm = TUC-S Drill depth

1.1



1.2



1.3



1.1 Use a blind-hole drill bit

1.2 Do not use a drill bit with a point angle

1.3 Do not use a worn-out drill bit

Life expectancy for SFS drill bits

Drill bit	in HPL	in fibre cement
HSS	100-150 drills	25-100 drills
VHM	500+ drills	250-500 drills

1.4



1.4 Panel must lie on a hard surface

1.5

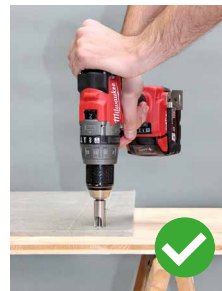

1.5 Keep a right angle during the drill process

1.6



1.6 Clean drill-hole from dirt

2. Position the bracket

Position the pre-drilled bracket over the hole in the panel and push through the TU-fastener

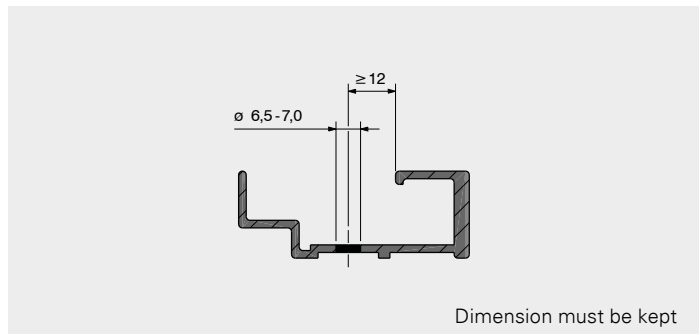
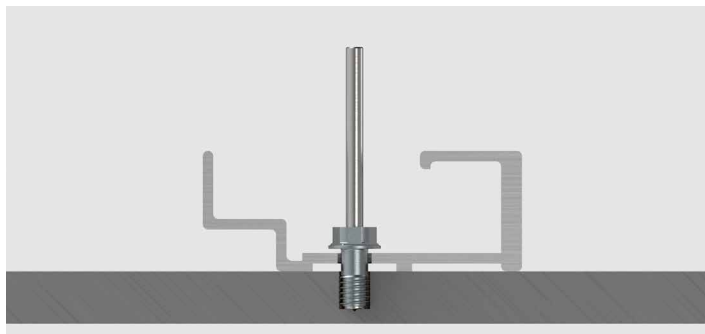

2.2

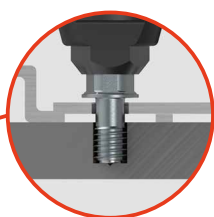

2.2
There is a gap
between the
TU-fastener head and
the bracket

2.3

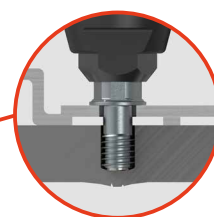

2.3
Giving heavy force
to the TU-fastener
while not removing
the mandrel can
cause damage to
the panel

3. Remove mandrel

Remove the mandrel using the GESIPA® PowerBird® Pro riveting tool combined with nose piece 17/36 or 17/40



3.1



3.1
Panel must lie on
a hard surface

3.2



3.2
Keep a right angle
during the setting
process

Push the GESIPA®
PowerBird® Pro
slightly towards
the panel